

8f [Bc" E 8<' A

F9A CJ 9'5@@6l FFG5B8 'G<5FD'98; 9G'

Hk #8 '5B; @9'DFC >97 Hc B"

		INCH	MM
CROWN WHEEL BOLT PCD	D1	5.1878	131.77
No. OF BOLTS		8	8
THREAD / THRO' HOLE		0.44	11.176
CROWN WHEEL SPIGOT DIA	D2	4.5016	114.3406
BEARING DIA	D3	1.7849	45.3365
BEARING DISTANCE	L1	5.2499	133.3475
SPIGOT LENGTH	L2	0.8365	21.2471
	L2/A	0.8316	21.1226
OVERALL LENGTH	L3	6.918	175.7172
BEARING/CROWN WHEEL	L4	1.6355	41.5417
BORE	D4	1.2878	32.7101
DRIVE SHAFT SPLINE:-		BROACH NR 89	
No. OF TEETH		28	
PITCH		24/48	
TYPE		FILLET ROOT	SIDE FIT
PRESSURE ANGLE		45°	

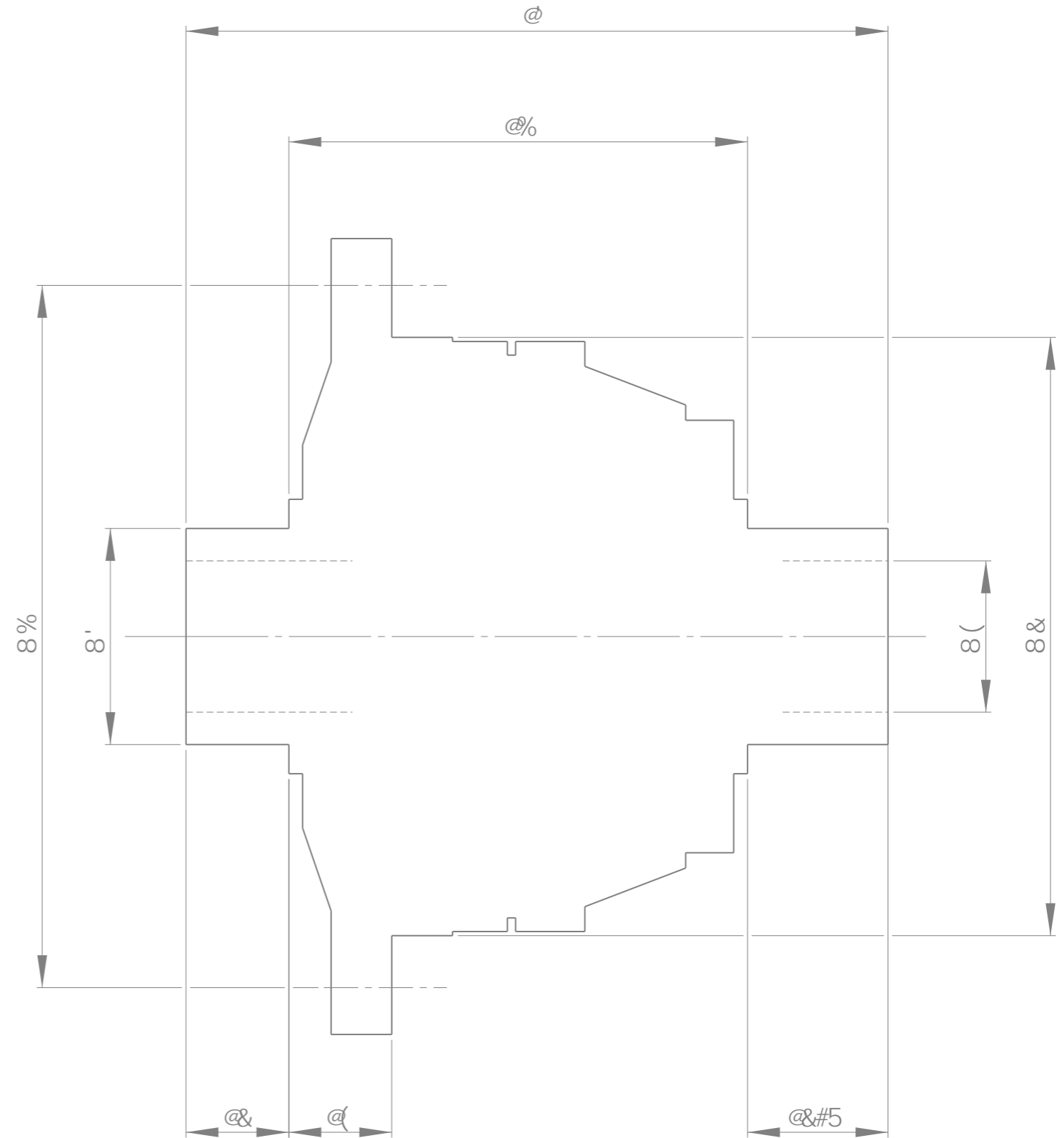

H#9 : "K "8" "8 ÷: '85 H5 'G<99H'
 G7 5@9%'%l "C "G" G<99H% C : '%
Fti 0Pq0 E 8<' A

S wclkg'F guli p'(' 'F gxgnro gpw0

÷ 'B '8C I 6H 5G?"

H: 6BF5K B: CF 89G: B 6GF-7HM
 7CB: 89B56/ H: 97C DM: <HK-9'9B
 H: 97.7 8 G: 93F CDFIMC:
 F: 15-99B: 89F: B: 982
 588 A 5MBCH691 098 7C D98 CF 9L- 6H98
 K H: C I H: 9F K F H86 D9A 4DC B'

: B G<"A 57 <ž '... ; F B84 ;
 @A #G": F57 H'± '%#* ("'
 897 "' + '\$\$\$\$)' "'
 A 5 H9F 5@ '...
 HF 95HA 9BH'...
 GG 9" \$% 85H9" %%"%\$"\$*
 8F5K B '6M <"F"
Wugf 'Kp0 A CF; 5B J, '59FC