

SECTION A-A

NOTE:-QUAIFE PARTS SHOWN ABOVE. FOR ALL OTHER COMPONENTS NOT SHOWN USE ORIGINAL FORD COMPONENTS.

TITLE	CLUSTER ASSEMBLY
SCALE	1:1 U.O.S.
SHEET	1 OF 2
Drg. No.	E-3Z1-01

IF IN DOUBT, ASK.

Quaife Design & Development.

FINISH.	MACH.	GRIND@G
LIMITS.	FRACT. $\pm 1/64"$	
	DEC. $\pm 0.005"$	
MATERIAL.		
TREATMENT.		
ISSUE.	02	DATE. 4.4.03
DRAWN BY.	M.L.M.	
Used In.	QUAIFE FORD BULLIT SYNCHRO	

ITEM NO.	PART NUMBER	DESCRIPTION	QTY.
1	E-3Z2-02	1ST GEAR M/S, 25T - R2.500:1/R2.225:1	1
2	E-3Z2-03	2ND GEAR M/S, 21T - R1.660:1/R1.495:1	1
3	E-3Z2-04	M/S 3rd GEAR. (R2.25 1st SET).	1
4	E-3Z1-18	INPUT SHAFT. R1:1 (LARGE SPIGOT. R2.25)	1
5	E-3Z3-31	LAYSHAFT INC 1ST/REV GEAR, R2.500:1	1
6	E-3Z3-32	2ND GEAR, L/S, 19T - R1.660:1/1.495:1	1
7	E-3Z3-33	3RD GEAR, L/S, 22T - R1.230:1	1
8	E-3Z3-35	4TH GEAR, L/S, 24T - R1.000:1	1
9	E-3Z3-37	SPACER, 3RD/4TH GEAR, L/S	1
10	E-3Z2-09	MAINBEARING SPACER	1
11	E-3Z1-15	MAINSHAFT LONG -LARGE SPIGOT	1
12	E-3Z1-19	1st GEAR BEARING SPACER	1
13	E-3Z1-17	I/P SHAFT. R1:1 (LARGE SPIGOT. R2.5 1st SET)	1
14	E-3Z2-10	3RD GEAR M/S, 18T - R1.230:1	1
15	E-3Z1-16	MAINSHAFT SHORT -LARGE SPIGOT	1
16	E-3Z2-23	M/S 1st GEAR. (R2.785)	1
17	E-3Z3-34	3RD GEAR, L/S, 22T - R1.168:1	1
18	E-3Z3-36	4TH GEAR, L/S, 23T - R1.000:1	1
19	FORD PART	BAULK RING 1st/2nd GEARS.	2
20	FORD PART	BAULK RING 3rd/4th GEARS.	2
21	FORD PART	REVERSE IDLER GEAR.	1
22	FORD PART	LAYSHAFT SPINDLE	1
23	FORD PART	NOSE CONE	1
24	FORD PART	BEARING - BALL 25x62x17	1
25	FORD PART	BUSH - 12 DU 16 TYPE, 3/4 x 7/8 x 1 LG	1

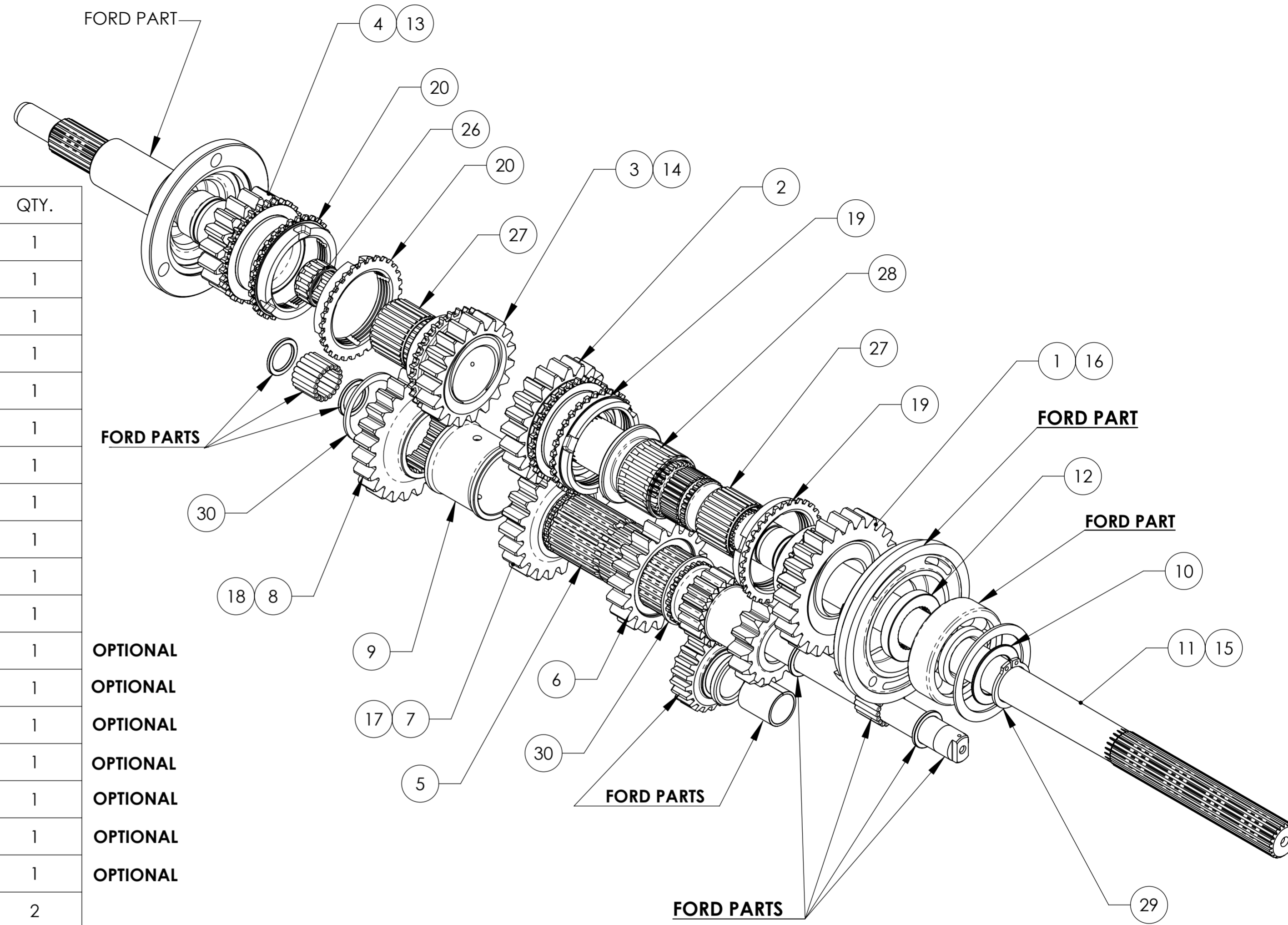

OPTIONAL
OPTIONAL
OPTIONAL
OPTIONAL
OPTIONAL
OPTIONAL

ITEM NO.	PART NUMBER	DESCRIPTION	QTY.
26	240	BEARING - ROLLER 20x26x13	1
27	244	BEARING - ROLLER 30x35x27	2
28	279	BEARING - ROLLER 35x40x27	1
29	293	CIRCLIP - EXTERNAL	1
30	2026	CIRCLIP, EXTERNAL	2

TITLE CLUSTER ASSEMBLY
SCALE 1:2 U.O.S. SHEET 2 OF 2
Drg. No. E-3Z1-01

Quaife Design & Development.

IF IN DOUBT, ASK.

FINISH. MACH. GRIND@G
LIMITS. FRACT. ± 1/64".
DEC. ± 0.005".
MATERIAL.
TREATMENT.
ISSUE. 02 DATE. 4.4.03
DRAWN BY. M.L.M.
Used In. QUAIFFORD BULLIT SYNCHRO