

		INCH	MM
BEARING DISTANCE	L1	3.293	83.63
SPIGOT LENGTH	L2	0.837	21.25
	L2/A	1.193	30.31
OVERALL LENGTH	L3	5.322	135.19
BEARING DIA	D3	1.969	50.00
	D3/A	1.969	50.00
DIFF BODY BORE	D4	1.353	34.36
SUN GEAR BORE	D5	0.980	24.90
DRIVE SHAFT SPLINE:-		DIFF BODY	SUN GEAR
No. OF TEETH		33	24
PITCH		24/48	
TYPE		FILLET ROOT SIDE FIT	
PRESSURE ANGLE		45 DEG	

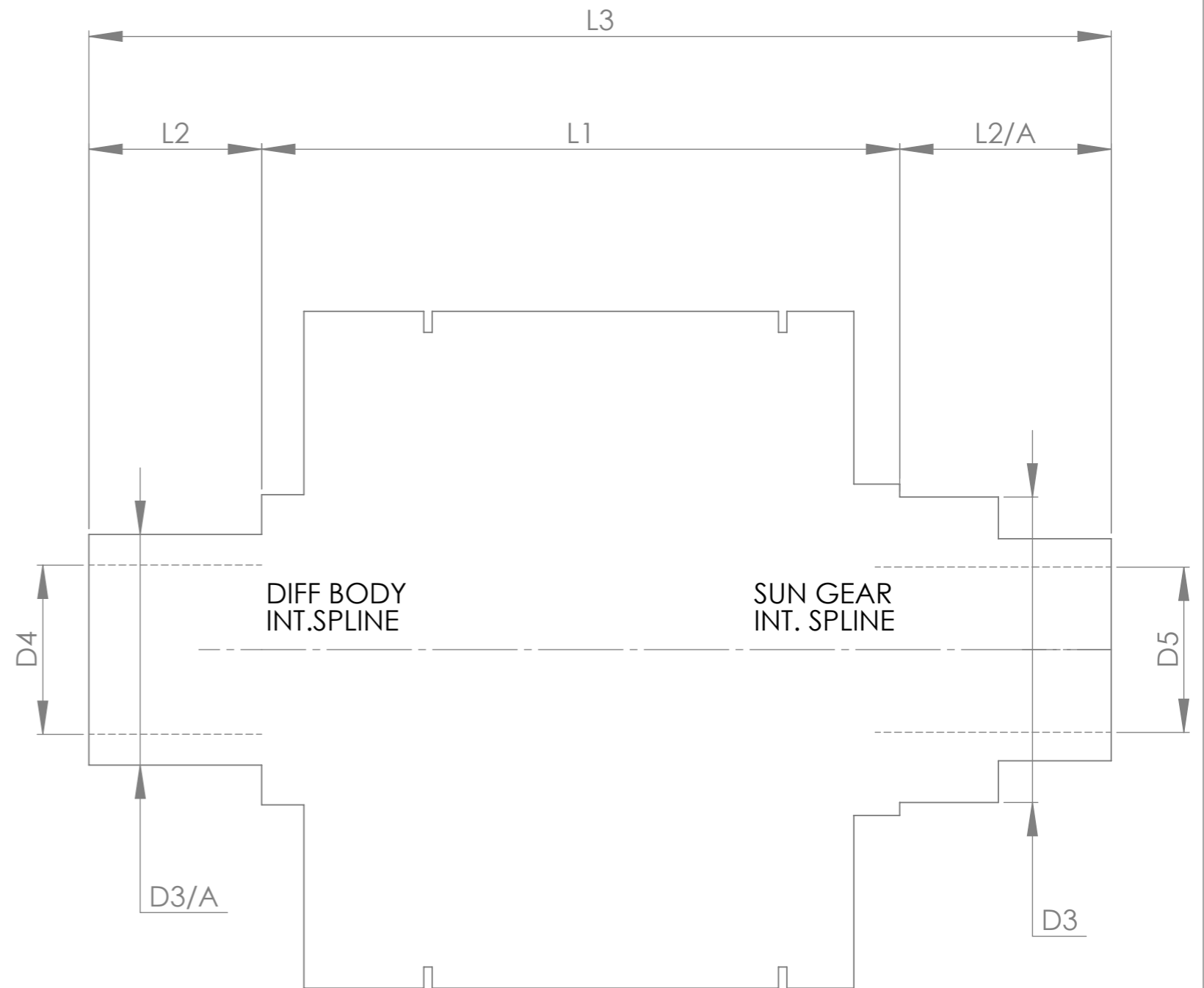

TITLE LANCIA DELTA INTEGRALE
SCALE 1:1 U.O.S. SHEET 1 OF 1
<b>Drg. No. QDH6K</b>

**Quaife Design & Development.**

IF IN DOUBT, ASK.

THIS DRAWING OR DESIGN IS STRICTLY CONFIDENTIAL & THE COPYRIGHT THEREIN THE EXCLUSIVE PROPERTY OF R.T. QUAIFE ENGINEERING LTD. AND MAY NOT BE USED COPIED OR EXHIBITED WITHOUT THEIR WRITTEN PERMISSION.

FINISH. MACH,	GRIND@G
LIMITS. FRACT. ± 1/64".	
DEC. ± 0.005".	
MATERIAL.	
TREATMENT.	
ISSUE. 01 DATE. 29/03/2016	
DRAWN BY. A.N.	

**Used In.**